

1-800-BOLLARDS

The Bollard Experts

- SELECT DESIRED MATERIAL:
(3" NOMINAL SIZE)
- RPSS03000 SCH 10 STAINLESS STEEL
 - RPSS03040 SCH 40 STAINLESS STEEL
 - RPSS03080 SCH 80 STAINLESS STEEL
 - RPCS03040 SCH 40 ASTM A-53 CARBON STEEL
 - RPCS03080 SCH 80 ASTM A-53 CARBON STEEL

- SELECT DESIRED STAINLESS STEEL BOLLARD FINISH:
- POLISHED #4 FINISH
 - AS SPECIFIED _____

- SELECT DESIRED CARBON STEEL BOLLARD FINISH:
- POWDER COAT RAL # _____
 - AS SPECIFIED _____

- SELECT DESIRED STAINLESS STEEL BOLLARD MATERIAL:
- TYPE 304
 - TYPE 316

- SELECT DESIRED BOLLARD CAP STYLE:
- DOME (SHOWN)
 - STANDARD FLAT
 - REVEAL
 - SLOPED

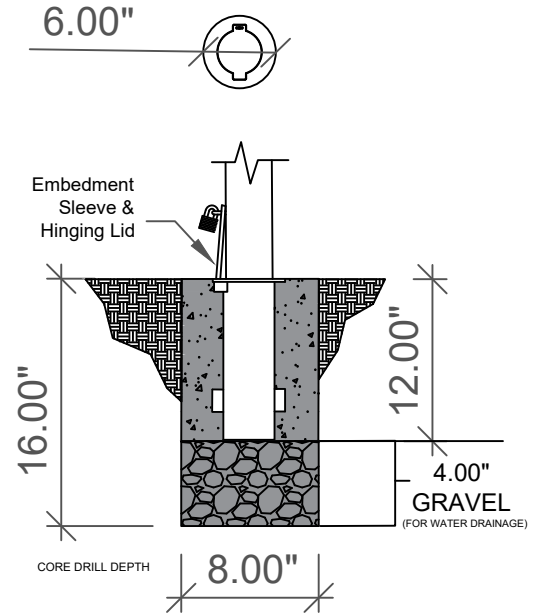
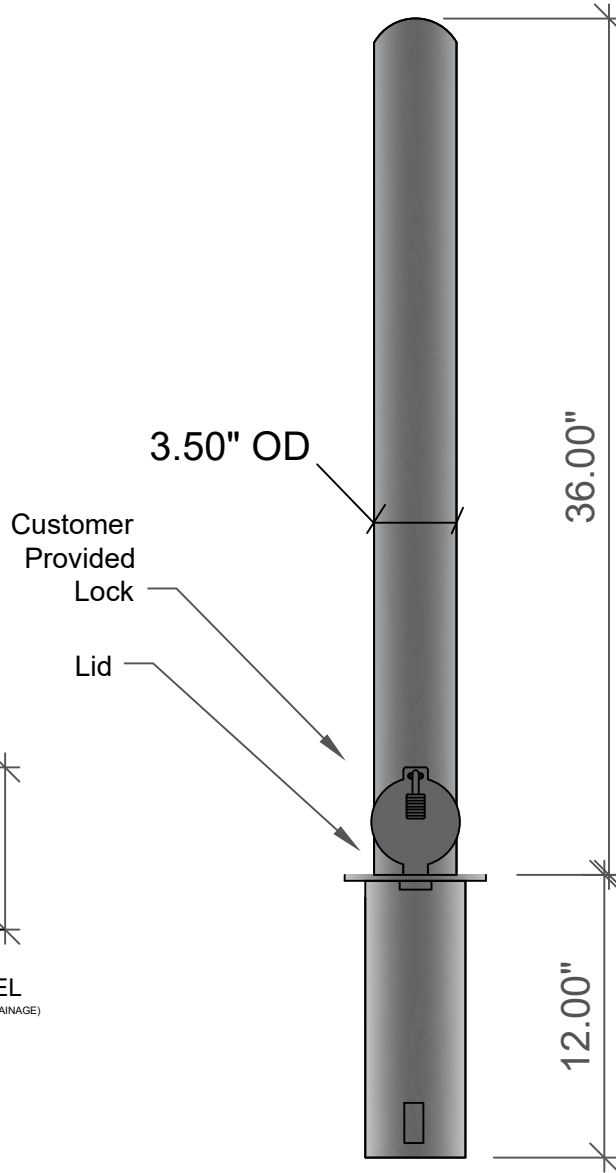
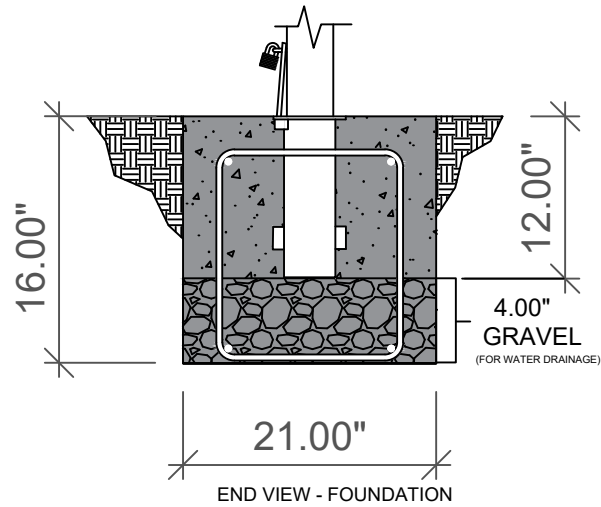

CORE DRILL MINIMUM DIAMETER

DOME (SHOWN) STANDARD FLAT REVEAL SLOPED



REVISIONS			
LTR	DESCRIPTION	DATE	APPV'D
COMMENTS			
SPECIFICATIONS			
HEIGHT: 36"			
DIAMETER: 3.50"			
WALL THICKNESS: 0.280" SCHED 40			

APPLICATION		SERIES NUMBER	CAGE CODE	REV	DRAWING NUMBER
NEXT ASSY	USED ON	1-800-BOLLARDS, Inc.	6NGJB		6th Cutsheet Size A - R1
		10 Hughes Suite A105			
		Irvine, CA 92618			
		PHONE: 1-800-BOLLARDS			
		WEB: www.1800BOLLARDS.COM			
		EMAIL: info@1800BOLLARDS.COM			
		PRODUCT CLASS: STANDARD OR CUSTOMER DEFINED	DRAWN BY: AJA		DRAWING REV:
		PRODUCT LINE: BOLLARD	CHECKED BY:		SHEET: 1 OF 1
		PRODUCT SUB LINE: PADLOCK REMOVABLE	APPROVED BY:		RELEASE DATE:
			TITLE:		
					BOLLARD, PADLOCK REMOVABLE

NOTES:
1. INSTALLATION TO BE COMPLETED IN ACCORDANCE WITH MANUFACTURER'S SPECIFICATIONS.
2. DO NOT SCALE DRAWING.
3. THIS DRAWING IS INTENDED FOR USE BY ARCHITECTS, ENGINEERS, CONTRACTORS, CONSULTANTS AND DESIGN PROFESSIONALS FOR PLANNING PURPOSES ONLY. THIS DRAWING
4. ALL INFORMATION CONTAINED HEREIN WAS CURRENT AT THE TIME OF DEVELOPMENT BUT MUST BE REVIEWED AND APPROVED BY THE PRODUCT MANUFACTURER TO BE CONSIDERED ACCURATE.